

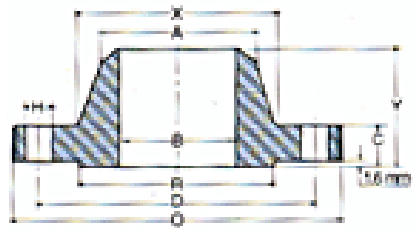

BRIDAS EMI GROUP S.A.

Serie 150



Con Cuello para Soldar
WN

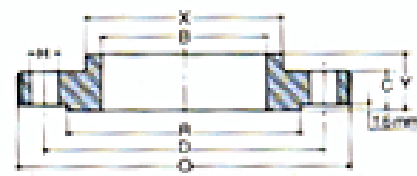

Deslizantes
SO



Ciegas
B

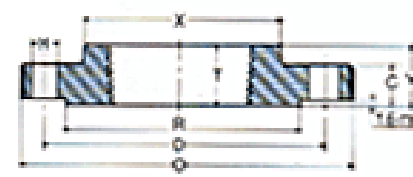

Roscadas
Tr

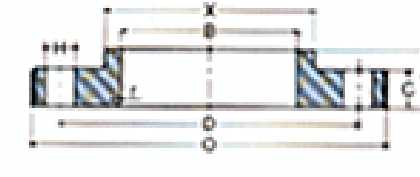

Para Junta con Solapa
LJ

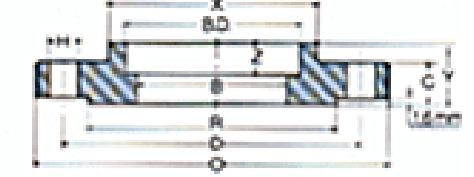

Con Asiento para Soldar
SW

Diámetro Nominal del Tubo	Diámetro Exterior O	Espesor Mínimo C*	Diámetro del Resalto R	Diámetro en la Base del Cubo X	Altura a través del cubo			Longitud Roscada Mínima T*	Diámetro Interior		
					WN	SO SW Tr	Lj		WN SW	SO SW BD	LJ
					Y*	Y*	Y		B	B	B
1/2	88.9 3.50	11.2 0.44	35.1 1.38	30.2 1.19	47.8 1.88	15.7 0.62	15.7 0.62	15.7 0.62	22.4 0.88	22.9 0.90	
3/4	98.6 3.88	12.7 0.50	42.9 1.69	38.1 1.50	52.3 2.06	15.7 0.62	15.7 0.62	15.7 0.62	27.7 1.09	28.2 1.11	
1	108.0 4.25	14.2 0.56	50.8 2.00	49.3 1.94	55.6 2.19	17.5 0.69	17.5 0.69	17.5 0.69	34.5 1.36	35.1 1.38	
1 1/4	117.3 4.62	15.7 0.62	63.5 2.50	58.7 2.31	57.2 2.25	20.6 0.81	20.6 0.81	20.6 0.81	43.2 1.70	43.7 1.72	
1 1/2	127.0 5.00	17.5 0.69	73.2 2.88	65.0 2.56	62.0 2.44	22.4 0.88	22.4 0.88	22.4 0.88	49.5 1.95	50.0 1.97	
2	152.4 6.00	19.1 0.75	91.9 3.62	77.7 3.06	63.5 2.50	25.4 1.00	25.4 1.00	25.4 1.00	62.0 2.44	62.5 2.46	
2 1/2	177.8 7.00	22.4 0.88	104.6 4.12	90.4 3.56	69.9 2.75	28.4 1.12	28.4 1.12	28.4 1.12	74.7 2.94	75.4 2.97	
3	190.5 7.50	23.9 0.94	127.0 5.00	108.0 4.25	69.9 2.75	30.2 1.19	30.2 1.19	30.2 1.19	90.7 3.57	91.4 3.60	
3 1/2	215.9 8.50	23.9 0.94	139.7 5.50	122.2 4.81	71.4 2.81	31.8 1.25	31.8 1.25	31.8 1.25	103.4 4.07	104.1 4.10	
4	228.6 9.00	23.9 0.94	157.2 6.19	134.9 5.31	76.2 3.00	33.3 1.31	33.3 1.31	33.3 1.31	116.8 4.60	116.8 4.60	
5	254.0 10.00	23.9 0.94	185.7 7.31	163.6 6.44	88.9 3.50	36.6 1.44	36.6 1.44	36.6 1.44	143.8 5.66	144.5 5.69	
6	279.4 11.00	25.4 1.00	215.9 8.50	192.0 7.56	88.9 3.50	39.6 1.56	39.6 1.56	39.6 1.56	170.7 6.72	171.5 6.75	
8	342.9 13.50	28.4 1.12	269.7 10.62	246.1 9.69	101.6 4.0	44.5 1.75	44.5 1.75	44.5 1.75	221.5 8.72	222.3 8.75	
10	406.4 16.00	30.2 1.19	323.9 12.75	304.8 12.00	101.6 4.00	49.3 1.94	49.3 1.94	49.3 1.94	276.4 10.88	277.4 10.92	
12	482.6 19.00	31.8 1.25	381.0 15.00	365.3 14.38	114.3 4.50	55.6 2.19	55.6 2.19	55.6 2.19	327.2 12.88	328.2 12.92	
14	533.4 21.00	35.1 1.38	412.8 16.25	400.1 15.75	127.0 5.00	57.2 2.25	79.2 3.12	57.2 2.25	359.2 14.14	360.2 14.18	
16	596.9 23.50	36.6 1.44	469.9 18.50	457.2 18.00	127.0 5.00	63.5 2.50	87.4 3.44	63.5 2.50	410.5 16.16	411.2 16.19	
18	635.0 25.00	39.6 1.56	533.4 21.00	505.0 19.88	139.7 5.50	68.3 2.69	96.8 3.81	68.3 2.69	461.8 18.18	462.3 18.20	
20	698.5 27.50	42.9 1.69	584.2 23.00	558.8 22.00	144.5 5.69	73.2 2.88	103.1 4.06	73.2 2.88	513.1 20.20	514.4 20.25	
24	812.8 32.00	47.8 1.88	692.2 27.25	663.4 26.12	152.4 6.00	82.6 3.25	111.3 4.38	82.6 3.25	616.0 24.25	616.0 24.25	

Diámetro Nominal del Tubo	Diámetro en el punto de soldadura A	Radio Lj r	Profundidad del asiento Z	Plantilla de Perforar			Peso Aproximado por Brida				
				Diám. Círculo de Agujeros D	Cantidad	Diám. de Agujeros H	WN	SO	LJ	B	SW
							Tr				
1/2	21.3 0.84	3.0 0.12	9.7 0.38	60.5 2.38	4	15.7 0.62	0.7	0.5	0.5	0.6	0.5
3/4	26.7 1.05	3.0 0.12	11.2 0.44	69.9 2.75	4	15.7 0.62	0.9	0.7	0.7	0.8	0.7
1	33.5 1.32	3.0 0.12	12.7 0.50	79.2 3.12	4	15.7 0.62	1.1	0.9	0.9	1.0	0.9
1 1/4	42.2 1.66	4.8 0.19	14.2 0.56	88.9 3.50	4	15.7 0.62	1.4	1.2	1.2	1.4	1.2
1 1/2	48.3 1.90	6.4 0.25	15.7 0.62	98.6 3.88	4	15.7 0.62	1.9	1.4	1.4	1.8	1.4
2	60.5 2.38	7.9 0.31	17.5 0.69	120.7 4.75	4	19.1 0.75	2.7	2.3	2.3	2.7	2.4
2 1/2	73.2 2.88	7.9 0.31	19.1 0.75	139.7 5.50	4	19.1 0.75	4.2	3.6	3.6	4.4	3.8
3	88.9 3.50	9.7 0.38	20.6 0.81	152.4 6.00	4	19.1 0.75	5.6	4.0	4.0	5.6	4.2
3 1/2	101.6 4.00	9.7 0.38		177.8 7.00	8	19.1 0.75	6.4	5.1	5.1	6.5	5.4
4	114.3 4.50	11.2 0.44		190.5 7.50	8	19.1 0.75	7.5	5.9	5.9	7.7	6.3
5	141.2 5.56	11.2 0.44		215.9 8.50	8	22.4 0.88	9.2	6.8	6.8	9.1	7.3
6	168.4 6.63	12.7 0.50		241.3 9.50	8	22.4 0.88	12.4	8.1	8.1	11.8	8.6
8	219.2 8.63	12.7 0.50		298.5 11.75	8	22.4 0.88	19.5	12.8	12.8	20.4	13.7
10	273.1 10.75	12.7 0.50		362.0 14.25	12	25.4 1.00	26.7	17.9	17.9	31.8	19.2
12	323.9 12.75	12.7 0.50		431.8 17.00	12	25.4 1.00	37	27.5	27.5	50	29.3
14	355.6 14.00	12.7 0.50		476.3 18.75	12	28.4 1.12	52	37.2	41	62	39.6
16	406.4 16.00	12.7 0.50		539.8 21.25	16	28.4 1.12	64	48	54	84	51
18	457.2 18.00	12.7 0.50		577.9 22.75	16	31.8 1.25	73	54	62	99	58
20	508.0 20.00	12.7 0.50		635.0 25.00	20	31.8 1.25	90	66	75	128	72
24	609.6 24.00	12.7 0.50		749.3 29.50	20	35.1 1.38	121	95	107	188	103

Las medidas en negro están expresadas en milímetros, las de color en pulgadas.
* Los 1.6 mm del Resalto están incluidos en el espesor mínimo, en la altura a través del cuello o cubo y en la longitud roscada mínima. Esta tabla corresponde a bridas de cara con resalto.

Las medidas en negro están expresadas en milímetros, las de color en pulgadas.

Serie 300

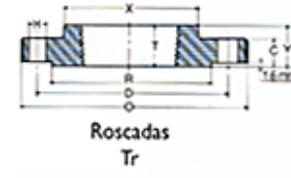
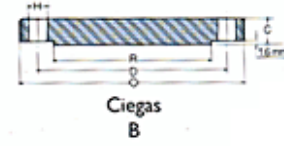
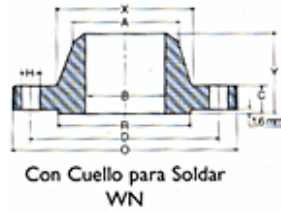

Diámetro Nominal del Tubo	Diámetro Exterior O	Espesor Mínimo C*	Diámetro del Resalto R	Diámetro en la Base del Cubo X	Altura a través del cubo			Longitud Roscada Mínima T*	Diámetro Interior		
					WN	SO SW Tr	LJ		WN SW	SO SW BD	LJ
					Y*	Y*	Y		B	B	B
1/2	95.3 3.75	14.2 0.56	35.1 1.38	38.1 1.50	52.3 2.06	22.4 0.88	22.4 0.88	15.7 0.62	22.4 0.88	22.9 0.90	
3/4	117.3 4.62	15.7 0.62	42.9 1.69	47.8 1.88	57.2 2.25	25.4 1.00	25.4 1.00	15.7 0.62	27.7 1.09	28.2 1.11	
1	124.0 4.88	17.5 0.69	50.8 2.00	53.8 2.12	62.0 2.44	26.9 1.06	26.9 1.06	17.5 0.69	34.5 1.36	35.1 1.38	
1 1/4	133.4 5.25	19.1 0.75	63.5 2.50	63.5 2.50	65.0 2.56	26.9 1.06	26.9 1.06	20.6 0.81	43.2 1.70	43.7 1.72	
1 1/2	155.4 6.12	20.6 0.81	73.2 2.88	69.9 2.75	68.3 2.69	30.2 1.19	30.2 1.19	22.4 0.88	49.5 1.95	50.0 1.97	
2	165.1 6.5	22.4 0.88	91.9 3.62	84.1 3.31	69.9 2.75	33.3 1.31	33.3 1.31	28.4 1.12	62.0 2.44	62.5 2.46	
2 1/2	190.5 7.50	25.4 1.00	104.6 4.12	100.1 3.94	76.2 3.00	38.1 1.50	38.1 1.50	31.8 1.25	74.7 2.94	75.4 2.97	
3	209.6 8.25	28.4 1.12	127.0 5.00	117.3 4.62	79.2 3.12	42.9 1.69	42.9 1.69	31.8 1.25	90.7 3.57	91.4 3.60	
3 1/2	228.6 9.00	30.2 1.19	139.7 5.50	133.4 5.25	81.0 3.19	44.5 1.75	44.5 1.75	36.6 1.44	103.4 4.07	104.1 4.10	
4	254.0 10.00	31.8 1.25	157.2 6.19	146.1 5.75	85.9 3.38	47.8 1.88	47.8 1.88	36.6 1.44	116.1 4.57	116.8 4.60	
5	279.4 11.00	35.1 1.38	185.7 7.31	177.8 7.00	98.6 3.88	50.8 2.00	50.8 2.00	42.9 1.69	143.8 5.66	144.5 5.69	
6	317.5 12.5	36.6 1.44	215.9 8.50	206.2 8.12	98.6 3.88	52.3 2.06	52.3 2.06	46.0 1.81	170.7 6.72	171.5 6.75	
8	381.0 15.00	41.1 1.62	269.7 10.62	260.4 10.25	111.3 4.38	62.0 2.44	62.0 2.44	50.8 2.00	221.5 8.72	222.3 8.75	
10	444.5 17.50	47.8 1.88	323.9 12.75	320.5 12.62	117.3 4.62	66.5 2.62	95.3 3.75	55.6 2.19	276.4 10.88	277.4 10.92	
12	520.7 20.50	50.8 2.00	381.0 15.00	374.7 14.75	130.0 5.12	73.2 2.88	101.6 4.00	60.5 2.38	327.2 12.88	328.2 12.92	
14	584.2 23.00	53.8 2.12	412.8 16.25	425.5 16.75	142.7 5.62	76.2 3.00	111.3 4.38	63.5 2.50	359.2 14.14	360.2 14.18	
16	647.7 25.50	57.2 2.25	469.9 18.50	482.6 19.00	146.1 5.75	82.6 3.25	120.7 4.75	68.3 2.69	410.5 16.16	411.2 16.19	
18	711.2 28.00	60.5 2.38	533.4 21.00	533.4 21.00	158.8 6.25	88.9 3.50	130.0 5.12	69.9 2.75	461.8 18.18	462.3 18.20	
20	774.7 30.50	63.5 2.50	584.2 23.00	587.2 23.12	162.1 6.38	95.3 3.75	139.7 5.50	73.2 2.88	513.1 20.20	514.4 20.25	
24	914.4 36.00	69.9 2.75	692.2 27.25	701.5 27.62	168.1 6.62	106.4 4.19	152.4 6.00	82.6 3.25	616.0 24.25	616.0 24.25	

Diámetro Nominal del Tubo	Diámetro en el punto de soldadura A	Radio Lj	Profundidad del asiento Z	Diámetro del asiento Q	Plantilla de Perforar			Peso Aproximado por Brida				
					Diám. Círculo de Agujeros D	Cantidad	Diám. de Agujeros H	WN	SO	LJ	B	SW
								Tr				
1/2	21.3 0.84	3.0 0.12	9.7 0.38	23.6 0.93	66.5 2.62	4	15.7 0.62	0.9	0.7	0.7	0.8	0.7
3/4	26.7 1.05	3.0 0.12	11.2 0.44	29.0 1.14	82.6 3.25	4	19.1 0.75	1.4	1.3	1.3	1.4	1.3
1	33.5 1.32	3.0 0.12	12.7 0.50	35.8 1.41	88.9 3.50	4	19.1 0.75	1.8	1.5	1.5	1.7	1.5
1 1/4	42.2 1.66	4.8 0.19	14.2 0.56	44.5 1.75	98.6 3.88	4	19.1 0.75	2.7	1.9	1.9	2.1	1.9
1 1/2	48.3 1.90	6.4 0.25	15.7 0.62	50.3 1.98	114.3 4.50	8	22.4 0.88	3.3	2.26	2.26	3.2	2.6
2	60.5 2.38	7.9 0.31	17.5 0.69	63.5 2.50	127.0 5.00	8	19.1 0.75	3.9	3.0	3.0	3.6	3.0
2 1/2	73.2 2.88	7.9 0.31	19.1 0.75	76.2 3.00	149.4 5.88	8	22.4 0.88	5.7	4.6	4.6	5.5	4.6
3	88.9 3.50	9.7 0.38	20.6 0.81	92.2 3.63	168.1 6.62	8	22.4 0.88	7.2	6.2	6.2	7.1	6.2
3 1/2	101.6 4.00	9.7 0.38		104.9 4.13	184.2 7.25	8	22.4 0.88	8.3	7.7	7.7	9.5	
4	114.3 4.50	11.2 0.44		117.6 4.63	200.2 7.88	8	22.4 0.88	11.5	9.8	9.8	11.7	
5	141.2 5.56	11.2 0.44		144.5 5.69	235.0 9.25	8	22.4 0.88	15.2	13.0	13.0	16.4	
6	168.4 6.63	12.7 0.50		171.5 6.75	269.7 10.62	12	22.4 0.88	20.1	16.2	16.2	22.2	
8	219.2 8.63	12.7 0.50		222.3 8.75	330.2 13.00	12	25.4 1.00	30.5	24.7	24.7	35	
10	273.1 10.75	12.7 0.50		276.4 10.88	387.4 15.25	16	28.4 1.12	45.3	36	41	56	
12	323.9 12.75	12.7 0.50		328.7 12.94	450.9 17.75	16	31.8 1.25	62.5	51	57	83	
14	355.6 14.00	12.7 0.50		360.4 14.19	514.4 20.25	20	31.8 1.25	86	73	85	109	
16	406.4 16.00	12.7 0.50		411.2 16.19	571.5 22.50	20	35.1 1.38	112	95	110	141	
18	457.2 18.00	12.7 0.50		462.0 18.19	628.7 24.75	24	35.1 1.38	138	125	138	183	
20	508.0 20.00	12.7 0.50		512.8 20.19	685.8 27.00	24	35.1 1.38	172	140	159	226	
24	609.6 24.00	12.7 0.50		614.4 24.19	812.8 32.00	24	41.1 1.62	247	221	242	352	

Las medidas en negro están expresadas en milímetros, las de color en pulgadas.
* Los 1.6 mm del Resalto están incluidos en el espesor mínimo, en la altura a través del cuello o cubo y en la longitud roscada mínima. Esta tabla corresponde a bridas de cara con resalto.

Las medidas en negro están expresadas en milímetros, las de color en pulgadas.

Serie 400

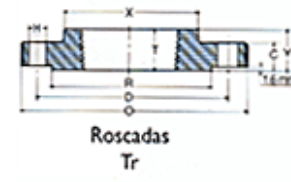
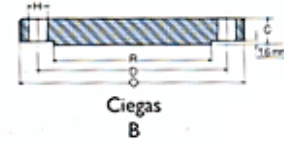
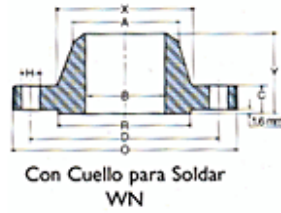

Diámetro Nominal del Tubo	Diámetro Exterior O	Espesor Mínimo C*	Diámetro del Resalto R	Diámetro en la Base del Cubo X	Altura a través del cubo			Longitud Roscada Mínima T*	Diámetro Interior		
					WN	SO SW Tr	Lj		WN	SO	LJ
					Y*	Y*	Y		B	B	B
1/2	95.3 3.75	14.2 0.56	35.1 1.38	38.1 1.50	52.3 2.06	22.4 0.88	22.4 0.88	15.7 0.62	22.4 0.88	22.9 0.90	
3/4	117.3 4.62	15.7 0.62	42.9 1.69	47.8 1.88	57.2 2.25	25.4 1.00	25.4 1.00	15.7 0.62	27.7 1.09	28.2 1.11	
1	124.0 4.88	17.5 0.69	50.8 2.00	53.8 2.12	62.0 2.44	26.9 1.06	26.9 1.06	17.5 0.69	34.5 1.36	35.1 1.38	
1 1/4	133.4 5.25	20.6 0.81	63.5 2.50	63.5 2.50	66.5 2.62	28.4 1.12	28.4 1.12	20.6 0.81	43.2 1.70	43.7 1.72	
1 1/2	155.4 6.12	22.4 0.88	73.2 2.88	69.9 2.75	69.9 2.75	31.8 1.25	31.8 1.25	22.4 0.88	49.5 1.95	50.0 1.97	
2	165.1 6.5	25.4 1.00	91.9 3.62	84.1 3.31	73.2 2.88	36.6 1.44	36.6 1.44	28.4 1.12	62.0 2.44	62.5 2.46	
2 1/2	190.5 7.50	28.4 1.12	104.6 4.12	100.1 3.94	79.2 3.12	41.1 1.62	41.1 1.62	31.8 1.25	74.7 2.94	75.4 2.97	
3	209.6 8.25	31.8 1.25	127.0 5.00	117.3 4.62	82.6 3.25	46.0 1.81	46.0 1.81	35.1 1.38	90.7 3.57	91.4 3.60	
3 1/2	228.6 9.00	35.1 1.38	139.7 5.50	133.4 5.25	85.9 33.38	49.3 1.94	49.3 1.94	39.6 1.56	103.4 4.07	104.1 4.10	
4	254.0 10.00	35.1 1.38	157.2 6.19	146.1 5.75	88.9 3.50	50.8 2.00	50.8 2.00	36.6 1.44	116.1 4.57	116.8 4.60	
5	279.4 11.00	38.1 1.50	185.7 7.31	177.8 7.00	101.6 4.00	53.8 2.12	53.8 2.12	42.9 1.69	143.8 5.66	144.5 5.69	
6	317.5 12.5	41.1 1.62	215.9 8.50	206.2 8.12	103.1 4.06	57.2 2.25	57.2 2.25	46.0 1.81	170.7 6.72	171.5 6.75	
8	381.0 15.00	47.8 1.88	269.7 10.62	260.4 10.25	117.3 4.62	68.3 2.69	68.3 2.69	50.8 2.00	221.5 8.72	222.3 8.75	
10	444.5 17.50	53.8 2.12	323.9 12.75	320.5 12.62	124.0 4.88	73.2 2.88	101.6 4.00	55.6 2.19	276.4 10.88	277.4 10.92	
12	520.7 20.50	57.2 2.25	381.0 15.00	374.7 14.75	136.7 5.38	79.2 3.12	108.0 4.25	60.5 2.38	327.2 12.88	328.2 12.92	
14	584.2 23.00	60.5 2.38	412.8 16.25	425.5 16.75	149.4 5.88	81.1 3.31	117.3 4.62	63.5 2.50	359.2 14.14	360.2 14.18	
16	647.7 25.50	63.5 2.50	469.9 18.50	482.6 19.00	152.4 6.00	93.7 3.69	127.0 5.00	68.3 2.69	410.5 16.16	411.2 16.19	
18	711.2 28.00	66.5 2.62	533.4 21.00	533.4 21.00	165.1 6.50	98.6 3.88	136.7 5.38	69.9 2.75	461.8 18.18	462.3 18.20	
20	774.7 30.50	69.9 2.75	584.2 23.00	587.2 23.12	168.1 6.62	101.6 4.00	146.1 5.75	73.2 2.88	513.1 20.20	514.4 20.25	
24	914.4 36.00	76.2 3.00	692.2 27.25	701.5 27.62	174.8 6.88	114.3 4.50	158.8 6.25	82.6 3.25	616.0 24.25	616.0 24.25	

Diámetro Nominal del Tubo	Diámetro en el punto de soldadura A	Radio r	Diámetro del asiento Q	Plantilla de Perforar			Peso Aproximado por Brida										
				Diám. Círculo de Agujeros D	Cantidad	Diám. de Agujeros H	WN	SO	LJ	B							
							Tr										
1/2	21.3 0.84	3.0 0.12	23.6 0.93	66.5 2.62	4	15.7 0.62	1.1	0.9	0.9	1							
3/4	26.7 1.05	3.0 0.12	29.0 1.14	82.6 3.25	4	19.1 0.75	1.6	1.5	1.5	1.6							
1	33.5 1.32	3.0 0.12	35.8 1.41	88.9 3.50	4	19.1 0.75	2.1	1.8	1.8	1.9							
1 1/4	42.2 1.66	4.8 0.19	44.5 1.75	98.6 3.88	4	19.1 0.75	3.0	2.6	2.6	2.7							
1 1/2	48.3 1.90	6.4 0.25	50.5 1.99	114.3 4.50	4	22.4 0.88	3.9	3.1	3.1	3.4							
2	60.5 2.38	7.9 0.31	63.5 2.50	127.0 5.00	8	19.1 0.75	4.4	4.0	4.0	4.0							
2 1/2	73.2 2.88	7.9 0.31	76.2 3.00	149.4 5.88	8	22.4 0.88	6.5	5.9	5.9	6.8							
3	88.9 3.50	9.7 0.38	92.2 3.63	168.1 6.62	8	22.4 0.88	8.8	7.5	7.5	9.1							
3 1/2	101.6 4.00	9.7 0.38	104.9 4.13	184.2 7.25	8	25.4 1.00	11.5	9.5	9.5	13.2							
4	114.3 4.50	11.2 0.44	117.6 4.63	200.2 7.88	8	25.4 1.00	13.5	11.5	11.5	15.0							
5	141.2 5.56	11.2 0.44	144.5 5.69	235.0 9.25	8	25.4 1.00	17.5	14.0	14.0	20.0							
6	168.4 6.63	12.7 0.50	171.5 6.75	269.7 10.62	12	25.4 1.00	22.2	17.5	17.5	27.7							
8	219.2 8.63	12.7 0.50	222.3 8.75	330.2 13.00	12	28.4 1.12	35.5	28.5	27.5	45							
10	273.1 10.75	12.7 0.50	276.4 10.88	387.4 15.25	16	31.8 1.25	50	41.5	43	70							
12	323.9 12.75	12.7 0.50	328.7 12.94	450.9 17.75	16	35.1 1.38	73	59	69	100							
14	355.6 14.00	12.7 0.50	360.4 14.19	514.4 20.25	20	31.8 1.25	106	87	95	127							
16	406.4 16.00	12.7 0.50	411.2 16.19	571.5 22.50	20	38.1 1.50	133	115	127	169							
18	457.2 18.00	12.7 0.50	462.0 18.19	628.7 24.75	24	38.1 1.50	163	141	157	220							
20	508.0 20.00	12.7 0.50	512.8 20.19	685.8 27.00	24	41.1 1.62	202	172	191	265							
24	609.6 24.00	12.7 0.50	614.4 24.19	812.8 32.00	24	47.8 1.88	290	245	279	390							

Las medidas en negro están expresadas en milímetros, las de color en pulgadas.
* Los 1.6 mm del Resalto están incluidos en el espesor mínimo, en la altura a través del cuello o cubo y en la longitud roscada mínima. Esta tabla corresponde a bridas de cara con resalto.

Las medidas en negro están expresadas en milímetros, las de color en pulgadas.

Serie 600

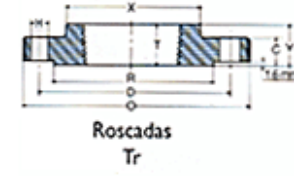
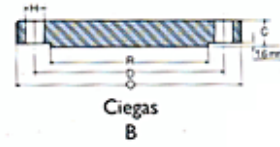
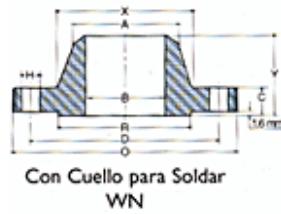

Diámetro Nominal del Tubo	Diámetro Exterior O	Espesor Mínimo C*	Diámetro del Resalto R	Diámetro en la Base del Cubo X	Altura a través del cubo			Longitud Roscada Mínima T*	Diámetro Interior		
					WN	SO SW Tr	Lj		WN	SO	LJ
					Y*	Y*	Y		B	B	B
1/2	95.3 3.75	14.2 0.56	35.1 1.38	38.1 1.50	52.3 2.06	22.4 0.88	22.4 0.88	15.7 0.62	22.4 0.88	22.9 0.90	
3/4	117.3 4.62	15.7 0.62	42.9 1.69	47.8 1.88	57.2 2.25	25.4 1.00	25.4 1.00	15.7 0.62	27.7 1.09	28.2 1.11	
1	124.0 4.88	17.5 0.69	50.8 2.00	53.8 2.12	62.0 2.44	26.9 1.06	26.9 1.06	17.5 0.69	34.5 1.36	35.1 1.38	
1 1/4	133.4 5.25	20.6 0.81	63.5 2.50	63.5 2.50	66.5 2.62	28.4 1.12	28.4 1.12	20.6 0.81	43.2 1.70	43.7 1.72	
1 1/2	155.4 6.12	22.4 0.88	73.2 2.88	69.9 2.75	69.9 2.75	31.8 1.25	31.8 1.25	22.4 0.88	49.5 1.95	50.0 1.97	
2	165.1 6.5	25.4 1.00	91.9 3.62	84.1 3.31	73.2 2.88	36.6 1.44	36.6 1.44	28.4 1.12	62.0 2.44	62.5 2.46	
2 1/2	190.5 7.50	28.4 1.12	104.6 4.12	100.1 3.94	79.2 3.12	41.1 1.62	41.1 1.62	31.8 1.25	74.7 2.94	75.4 2.97	
3	209.6 8.25	31.8 1.25	127.0 5.00	117.3 4.62	82.6 3.25	46.0 1.81	46.0 1.81	35.1 1.38	90.7 3.57	91.4 3.60	
3 1/2	228.6 9.00	35.1 1.38	139.7 5.50	133.4 5.25	85.9 33.38	49.3 1.94	49.3 1.94	39.6 1.56	103.4 4.07	104.1 4.10	
4	254.0 10.00	35.1 1.38	157.2 6.19	146.1 5.75	88.9 3.50	50.8 2.00	50.8 2.00	36.6 1.44	116.1 4.57	116.8 4.60	
5	279.4 11.00	38.1 1.50	185.7 7.31	177.8 7.00	101.6 4.00	53.8 2.12	53.8 2.12	42.9 1.69	143.8 5.66	144.5 5.69	
6	317.5 12.5	41.1 1.62	215.9 8.50	206.2 8.12	103.1 4.06	57.2 2.25	57.2 2.25	46.0 1.81	170.7 6.72	171.5 6.75	
8	381.0 15.00	47.8 1.88	269.7 10.62	260.4 10.25	117.3 4.62	68.3 2.69	68.3 2.69	50.8 2.00	221.5 8.72	222.3 8.75	
10	444.5 17.50	53.8 2.12	323.9 12.75	320.5 12.62	124.0 4.88	73.2 2.88	101.6 4.00	55.6 2.19	276.4 10.88	277.4 10.92	
12	520.7 20.50	57.2 2.25	381.0 15.00	374.7 14.75	136.7 5.38	79.2 3.12	108.0 4.25	60.5 2.38	327.2 12.88	328.2 12.92	
14	584.2 23.00	60.5 2.38	412.8 16.25	425.5 16.75	149.4 5.88	81.1 3.31	117.3 4.62	63.5 2.50	359.2 14.14	360.2 14.18	
16	647.7 25.50	63.5 2.50	469.9 18.50	482.6 19.00	152.4 6.00	93.7 3.69	127.0 5.00	68.3 2.69	410.5 16.16	411.2 16.19	
18	711.2 28.00	66.5 2.62	533.4 21.00	533.4 21.00	165.1 6.50	98.6 3.88	136.7 5.38	69.9 2.75	461.8 18.18	462.3 18.20	
20	774.7 30.50	69.9 2.75	584.2 23.00	587.2 23.12	168.1 6.62	101.6 4.00	146.1 5.75	73.2 2.88	513.1 20.20	514.4 20.25	
24	914.4 36.00	76.2 3.00	692.2 27.25	701.5 27.62	174.8 6.88	114.3 4.50	158.8 6.25	82.6 3.25	616.0 24.25	616.0 24.25	

Diámetro Nominal del Tubo	Diámetro en el punto de soldadura A	Radio r	Diámetro del asiento Q	Plantilla de Perforar			Peso Aproximado por Brida			
				Diám. Círculo de Agujeros D	Cantidad	Diám. de Agujeros H	WN	SO	LJ	B
							Tr			
1/2	21.3 0.84	3.0 0.12	23.6 0.93	66.5 2.62	4	15.7 0.62	1.1	0.9	0.9	1
3/4	26.7 1.05	3.0 0.12	29.0 1.14	82.6 3.25	4	19.1 0.75	1.6	1.5	1.5	1.6
1	33.5 1.32	3.0 0.12	35.8 1.41	88.9 3.50	4	19.1 0.75	2.1	1.8	1.8	1.9
1 1/4	42.2 1.66	4.8 0.19	44.5 1.75	98.6 3.88	4	19.1 0.75	3.0	2.6	2.6	2.7
1 1/2	48.3 1.90	6.4 0.25	50.5 1.99	114.3 4.50	4	22.4 0.88	3.9	3.1	3.1	3.4
2	60.5 2.38	7.9 0.31	63.5 2.50	127.0 5.00	8	19.1 0.75	4.4	4.0	4.0	4.0
2 1/2	73.2 2.88	7.9 0.31	76.2 3.00	149.4 5.88	8	22.4 0.88	6.5	5.9	5.9	6.8
3	88.9 3.50	9.7 0.38	92.2 3.63	168.1 6.62	8	22.4 0.88	8.8	7.5	7.5	9.1
3 1/2	101.6 4.00	9.7 0.38	104.9 4.13	184.2 7.25	8	25.4 1.00	11.5	9.5	9.5	13.2
4	114.3 4.50	11.2 0.44	117.6 4.63	200.2 7.88	8	25.4 1.00	13.5	11.5	11.5	15.0
5	141.2 5.56	11.2 0.44	144.5 5.69	235.0 9.25	8	25.4 1.00	17.5	14.0	14.0	20.0
6	168.4 6.63	12.7 0.50	171.5 6.75	269.7 10.62	12	25.4 1.00	22.2	17.5	17.5	27.7
8	219.2 8.63	12.7 0.50	222.3 8.75	330.2 13.00	12	28.4 1.12	35.5	28.5	27.5	45
10	273.1 10.75	12.7 0.50	276.4 10.88	387.4 15.25	16	31.8 1.25	50	41.5	43	70
12	323.9 12.75	12.7 0.50	328.7 12.94	450.9 17.75	16	35.1 1.38	73	59	69	100
14	355.6 14.00	12.7 0.50	360.4 14.19	514.4 20.25	20	31.8 1.25	106	87	95	127
16	406.4 16.00	12.7 0.50	411.2 16.19	571.5 22.50	20	38.1 1.50	133	115	127	169
18	457.2 18.00	12.7 0.50	462.0 18.19	628.7 24.75	24	38.1 1.50	163	141	157	220
20	508.0 20.00	12.7 0.50	512.8 20.19	685.8 27.00	24	41.1 1.62	202	172	191	265
24	609.6 24.00	12.7 0.50	614.4 24.19	812.8 32.00	24	47.8 1.88	290	245	279	390

Las medidas en negro están expresadas en milímetros, las de color en pulgadas.
* Los 1.6 mm del Resalto están incluidos en el espesor mínimo, en la altura a través del cuello o cubo y en la longitud roscada mínima. Esta tabla corresponde a bridas de cara con resalto.

Las medidas en negro están expresadas en milímetros, las de color en pulgadas.

Serie 600

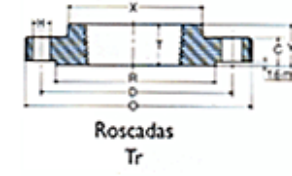
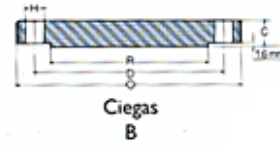
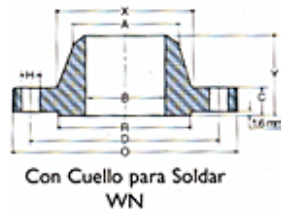

Diámetro Nominal del Tubo	Diámetro Exterior O	Espesor Mínimo C*	Diámetro del Resalto R	Diámetro en la Base del Cubo X	Altura a través del cubo			Longitud Roscada Mínima T*	Diámetro Interior		
					WN	SO SW Tr	LJ		WN SW	SO SW B	LJ
					Y*	Y*	Y		B	BD	B
1/2	95.3 3.75	14.2 0.56	35.1 1.38	38.1 1.50	52.3 2.06	22.4 0.88	22.4 0.88	15.7 0.62	22.4 0.88	22.9 0.90	
3/4	117.3 4.62	15.7 0.62	42.9 1.69	47.8 1.88	57.2 2.25	25.4 1.00	25.4 1.00	15.7 0.62	27.7 1.09	28.2 1.11	
1	124.0 4.88	17.5 0.69	50.8 2.00	53.8 2.12	62.0 2.44	26.9 1.06	26.9 1.06	17.5 0.69	34.5 1.36	35.1 1.38	
1 1/4	133.4 5.25	20.6 0.81	63.5 2.50	63.5 2.50	66.5 2.62	28.4 1.12	28.4 1.12	20.6 0.81	43.2 1.70	43.7 1.72	
1 1/2	155.4 6.12	22.4 0.88	73.2 2.88	69.9 2.75	69.9 2.75	31.8 1.25	31.8 1.25	22.4 0.88	49.5 1.95	50.0 1.97	
2	165.1 6.5	25.4 1.00	91.9 3.62	84.1 3.31	73.2 2.88	36.6 1.44	36.6 1.44	28.4 1.12	62.0 2.44	62.5 2.46	
2 1/2	190.5 7.50	28.4 1.12	104.6 4.12	100.1 3.94	79.2 3.12	41.1 1.62	41.1 1.62	31.8 1.25	74.7 2.94	75.4 2.97	
3	209.6 8.25	31.8 1.25	127.0 5.00	117.3 4.62	82.6 3.25	46.0 1.81	46.0 1.81	35.1 1.38	90.7 3.57	91.4 3.60	
3 1/2	228.6 9.00	35.1 1.38	139.7 5.50	133.4 5.25	85.9 33.38	49.3 1.94	49.3 1.94	39.6 1.56	103.4 4.07	104.1 4.10	
4	273.1 10.75	38.1 1.50	157.2 6.19	152.4 6.00	101.6 4.00	53.8 2.12	53.8 2.12	41.1 1.62	116.1 4.57	116.8 4.60	
5	330.2 13.00	44.5 1.75	185.7 7.31	189.0 7.44	114.3 4.50	60.5 2.38	60.5 2.38	47.8 1.88	143.8 5.66	144.5 5.69	
6	355.6 14.00	47.8 1.88	215.9 8.50	222.3 8.75	117.3 4.62	66.5 2.62	66.5 2.62	50.8 2.00	170.7 6.72	171.5 6.75	
8	419.1 16.50	55.6 2.19	269.7 10.62	273.1 10.75	133.4 5.25	76.2 3.00	76.2 3.00	57.2 2.25	221.5 8.72	222.3 8.75	
10	508.0 20.00	63.5 2.50	323.9 12.75	342.9 13.50	152.4 6.00	85.9 3.38	111.3 4.38	65.0 2.56	276.4 10.88	277.4 10.92	
12	558.8 22.00	66.5 2.62	381.0 15.00	400.1 15.75	155.4 6.12	91.9 3.62	117.3 4.62	69.9 2.75	327.2 12.88	328.2 12.92	
14	603.3 23.75	69.9 2.75	412.8 16.25	431.8 17.00	165.1 6.50	93.7 3.69	127.0 5.00	73.2 2.88	359.2 14.14	360.2 14.18	
16	685.8 27.00	76.2 3.00	469.9 18.50	495.3 19.50	177.8 7.00	106.4 4.19	139.7 5.50	77.7 3.06	410.5 16.16	411.2 16.19	
18	743.0 29.25	82.6 3.25	533.4 21.00	546.1 21.50	184.2 7.25	117.3 4.62	152.4 6.00	79.2 3.12	461.8 18.18	462.3 18.20	
20	812.8 32.00	88.9 3.50	584.2 23.00	609.6 24.00	190.5 7.50	127.0 5.00	165.1 6.50	82.6 3.25	513.1 20.20	514.4 20.25	
24	939.8 37.00	101.6 4.00	692.2 27.25	717.6 28.25	203.2 8.00	139.7 5.50	184.2 7.25	91.9 3.62	616.0 24.25	616.0 24.25	

Diámetro Nominal del Tubo	Diámetro en el punto de soldadura A	Radio r	Profundidad del Asiento Z	Diámetro del asiento Q	Plantilla de Perforar			Peso Aproximado por Brida				
					Diám. Círculo de Agujeros D	Cantidad	Diám. de Agujeros H	WN	SO	LJ	B	SW
								Kg	Kg	Kg	Kg	Kg
1/2	21.3 0.84	3.0 0.12	9.7 0.38	23.6 0.93	66.5 2.62	4	15.7 0.62	1.1	0.9	0.9	1.0	1.0
3/4	26.7 1.05	3.0 0.12	11.2 0.44	29.0 1.14	82.6 3.25	4	19.1 0.75	1.6	1.5	1.5	1.6	1.6
1	33.5 1.32	3.0 0.12	12.7 0.50	35.8 1.41	88.9 3.50	4	19.1 0.75	2.1	1.8	1.8	1.9	1.9
1 1/4	42.2 1.66	4.8 0.19	14.2 0.56	44.5 1.75	98.6 3.88	4	19.1 0.75	3.0	2.6	2.6	2.7	2.7
1 1/2	48.3 1.90	6.4 0.25	15.7 0.62	50.5 1.99	114.3 4.50	4	22.4 0.88	3.9	3.1	3.1	3.4	3.4
2	60.5 2.38	7.9 0.31	17.5 0.69	63.5 2.50	127.0 5.00	8	19.1 0.75	4.4	4.0	4.0	4.4	4.4
2 1/2	73.2 2.88	7.9 0.31	19.1 0.75	76.2 3.00	149.4 5.88	8	22.4 0.88	6.5	5.9	5.9	6.8	6.8
3	88.9 3.50	9.7 0.38	20.6 0.81	92.2 3.63	168.1 6.62	8	22.4 0.88	8.8	7.5	7.5	9.1	9.1
3 1/2	101.6 4.00	9.7 0.38		104.9 4.13	184.2 7.25	8	25.4 1.00	11.5	9.5	9.5	13.2	
4	114.3 4.50	11.2 0.44		117.6 4.63	215.9 8.50	8	25.4 1.00	19.5	15.1	15.1	18.5	
5	141.2 5.56	11.2 0.44		144.5 5.69	266.7 10.50	8	28.4 1.12	29.1	24.1	24.1	30.9	
6	168.4 6.63	12.7 0.50		171.5 6.75	292.1 11.50	12	28.4 1.12	35	29	29	39	
8	219.2 8.63	12.7 0.50		222.3 8.75	349.3 13.75	12	31.8 1.25	54	49	49	62	
10	273.1 10.75	12.7 0.50		276.4 10.88	431.8 17.0	16	35.1 1.38	86	75	81	101	
12	323.9 12.75	12.7 0.50		328.7 12.94	489.0 19.25	20	35.1 1.38	102	89	97	134	
14	355.6 14.00	12.7 0.50		360.4 14.19	527.1 20.75	20	38.1 1.50	160	110	121	172	
16	406.4 16.00	12.7 0.50		411.2 16.19	603.3 23.75	20	41.1 1.62	216	166	181	227	
18	457.2 18.00	12.7 0.50		462.0 18.19	654.1 25.75	20	44.5 1.75	252	219	237	285	
20	508.0 20.00	12.7 0.50		512.8 20.19	723.9 28.50	24	44.5 1.75	316	276	301	377	
24	609.6 24.00	12.7 0.50		614.4 24.19	838.2 33.00	24	50.8 2.00	450	339	374	551	

Las medidas en negro están expresadas en milímetros, las de color en pulgadas.
* Los 1.6 mm del Resalto están incluidos en el espesor mínimo, en la altura a través del cuello o cubo y en la longitud roscada mínima. Esta tabla corresponde a bridas de cara con resalto.

Las medidas en negro están expresadas en milímetros, las de color en pulgadas.

Serie 900

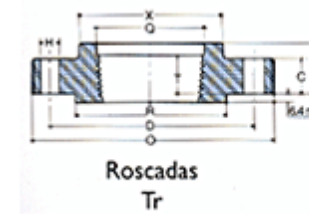
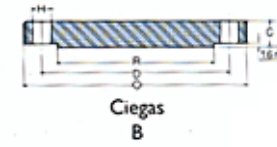
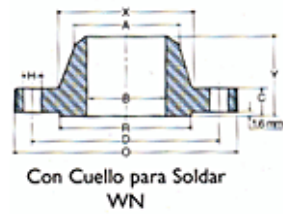

Diámetro Nominal del Tubo	Diámetro Exterior O	Espesor Mínimo C*	Diámetro del Resalto R	Diámetro en la Base del Cubo X	Altura a través del cubo			Longitud Roscada Mínima T*	Diámetro Interior			Diámetro Nominal del Tubo	Diámetro en el punto de soldadura A	Radio Lj	Diámetro del asiento Q	Plantilla de Perforar			Peso Aproximado por Brida			
					WN	SO SW Tr	Lj		WN	SO	LJ					Diám.Círculo de Agujeros D	Cantidad	Diám.de Agujeros H	WN	SO	LJ	B
					Y*	Y*	Y		B	B	B								Kg	Kg	Kg	Kg
1/2	127.7 4.75	22.4 0.88	35.1 1.38	38.1 1.50	60.5 2.38	31.8 1.25	31.8 1.25	22.4 0.88	22.4 0.88	22.9 0.90	1/2	21.3 0.84	3.0 0.12	23.6 0.93	82.6 3.25	4	22.4 0.88	2.3	2.1	2.1	2.0	
3/4	130.0 5.12	25.4 1.00	42.9 1.69	44.5 1.75	69.9 2.75	35.1 1.38	35.1 1.38	25.4 1.00	27.7 1.09	28.2 1.11	3/4	26.7 1.05	3.0 0.12	29.0 1.14	88.9 3.50	4	22.4 0.88	3.2	2.8	2.8	2.7	
1	149.4 5.88	28.4 1.12	50.8 2.00	52.3 2.06	73.2 2.88	41.1 1.62	41.1 1.62	28.4 1.12	34.5 1.36	35.1 1.38	1	33.5 1.32	3.0 0.12	35.8 1.41	101.6 4.00	4	25.4 1.00	4.1	3.9	3.9	4.1	
1 1/4	158.8 6.25	28.4 1.12	63.5 2.50	63.5 2.50	73.2 2.88	41.1 1.62	41.1 1.62	30.2 1.19	43.2 1.70	43.7 1.72	1 1/4	42.2 1.66	4.8 0.19	44.5 1.75	111.3 4.38	4	25.4 1.00	4.5	4.3	4.3	4.5	
1 1/2	177.8 7.00	31.8 1.25	73.2 2.88	69.9 2.75	82.6 3.25	44.5 1.75	44.5 1.75	31.8 1.25	49.5 1.95	50.0 1.97	1 1/2	48.3 1.90	6.4 0.25	50.5 1.99	124.0 4.88	4	28.4 1.12	6.4	6.0	6.0	6.4	
2	215.9 8.5	38.1 1.50	91.9 3.62	104.6 4.12	101.6 4.00	57.2 2.25	57.2 2.25	38.1 1.50	62.0 2.44	62.5 2.46	2	60.5 2.38	7.9 0.31	63.5 2.50	165.1 6.50	8	25.4 1.00	12.0	10.5	10.5	11.3	
2 1/2	244.3 9.62	41.1 1.62	104.6 4.12	124.0 4.88	104.6 4.12	63.5 2.50	63.5 2.50	47.8 1.88	74.7 2.94	75.4 2.97	2 1/2	73.2 2.88	7.9 0.31	76.2 3.00	190.5 7.50	8	28.4 1.12	16.3	11.3	11.3	15.9	
3	241.3 9.50	38.1 1.50	127.0 5.00	127.0 5.00	101.6 4.00	53.8 2.12	53.8 2.12	41.1 1.62	90.7 3.57	91.4 3.60	3	88.9 3.50	9.7 0.38	92.2 3.63	190.5 7.50	8	25.4 1.00	14.5	14.1	14.1	14.5	
4	292.1 11.50	44.5 1.75	157.2 6.19	158.8 6.25	114.3 4.50	69.9 2.75	69.9 2.75	47.8 1.88	116.1 4.57	116.8 4.60	4	114.3 4.50	11.2 0.44	117.6 4.63	235.0 9.25	8	31.8 1.25	23.2	23.0	23.0	24.5	
5	349.3 13.75	50.8 2.00	185.7 7.31	190.5 7.50	127.0 5.00	79.2 3.12	79.2 3.12	53.8 2.12	143.8 5.66	144.5 5.69	5	141.2 5.56	11.2 0.44	144.5 5.69	279.4 11.00	8	35.1 1.38	39	38	38	39	
6	381.0 15.00	55.6 2.19	215.9 8.50	235.0 9.25	139.7 5.50	85.9 3.38	85.9 3.38	57.2 2.25	170.7 6.72	171.5 6.75	6	168.4 6.63	12.7 0.50	171.5 6.75	317.5 12.50	12	31.8 1.25	50	49	49	51	
8	469.9 18.50	63.5 2.50	269.7 10.62	298.5 11.75	162.1 6.38	101.6 4.00	114.3 4.50	63.5 2.50	221.5 8.72	222.3 8.75	8	219.2 8.63	12.7 0.50	222.3 8.75	393.7 15.50	12	38.1 1.50	85	78	85	89	
10	546.1 21.50	69.9 2.75	323.9 12.75	368.3 14.50	184.2 7.25	108.0 4.25	127.0 5.00	71.4 2.81	276.4 10.88	277.4 10.92	10	273.1 10.75	12.7 0.50	276.4 10.88	469.9 18.50	16	38.1 1.50	122	111	126	132	
12	609.6 24.00	79.2 3.12	381.0 15.00	419.1 16.50	200.2 7.88	117.3 4.62	142.7 5.62	76.2 3.00	327.2 12.88	328.2 12.92	12	323.9 12.75	12.7 0.50	328.7 12.94	533.4 21.00	20	38.1 1.50	169	148	168	188	
14	641.4 25.25	85.9 3.38	412.8 16.25	450.9 17.75	212.9 8.38	130.0 5.12	155.4 6.12	82.6 3.25	359.2 14.14	360.2 14.18	14	355.6 14.00	12.7 0.50	360.4 14.19	558.8 22.00	20	41.1 1.62	255	173	187	224	
16	704.9 27.75	88.9 3.50	469.9 18.50	508.0 20.00	215.9 8.50	133.4 5.25	165.1 6.50	85.9 3.38	410.5 16.16	411.2 16.19	16	406.4 16.00	12.7 0.50	411.2 16.19	616.0 24.25	20	44.5 1.75	311	208	222	281	
18	787.4 31.00	101.6 4.00	533.4 21.00	565.2 22.25	228.6 9.00	152.4 6.00	190.5 7.50	88.9 3.50	461.8 18.18	462.3 18.20	18	457.2 18.00	12.7 0.50	462.0 18.19	685.8 27.00	20	50.8 2.00	419	294	304	400	
20	857.3 33.75	108.0 4.25	584.2 23.00	622.3 24.50	247.7 9.75	158.8 6.25	209.6 8.25	91.9 3.62	513.1 20.20	514.4 20.25	20	508.0 20.00	12.7 0.50	512.8 20.19	749.3 29.50	20	53.8 2.12	528	360	394	503	
24	1041.4 41.00	139.7 5.50	692.2 27.25	749.3 29.50	292.1 11.50	203.2 8.00	266.7 10.50	101.6 4.00	616.0 24.25	616.0 24.25	24	609.6 24.00	12.7 0.50	614.4 24.19	901.7 35.50	20	66.5 2.62	957	672	753	953	

Las medidas en negro están expresadas en milímetros, las de color en pulgadas.

* Los 1.6 mm del Resalto están incluidos en el espesor mínimo, en la altura a través del cuello o cubo y en la longitud roscada mínima. Esta tabla corresponde a bridas de cara con resalto.

Las medidas en negro están expresadas en milímetros, las de color en pulgadas.

Serie 1500

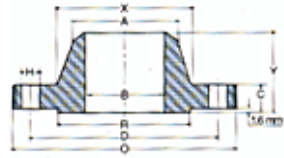

Con Cuello para Soldar
WN

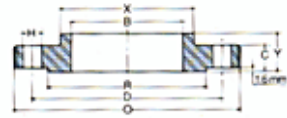

Deslizantes
SO



Ciegas
B

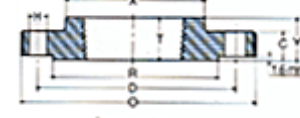

Roscadas
Tr

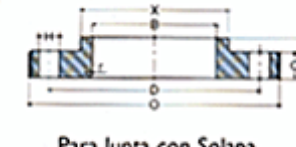

Para Junta con Solapa
LJ

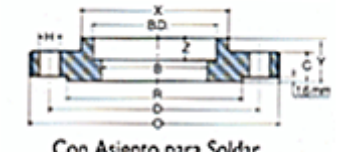

Con Asiento para Soldar
SW

Diámetro Nominal del Tubo	Diámetro Exterior O	Espesor Mínimo C*	Diámetro del Resalto R	Diámetro en la Base del Cubo X	Altura a través del cubo			Longitud Roscada Mínima T*	Diámetro Interior		
					WN	SO SW Tr	Lj		WN	SO	LJ
					Y*	Y*	Y		B	B	B
1/2	127.7 4.75	22.4 0.88	35.1 1.38	38.1 1.50	60.5 2.38	31.8 1.25	31.8 1.25	22.4 0.88	22.4 0.88	22.9 0.90	
3/4	130.0 5.12	25.4 1.00	42.9 1.69	44.5 1.75	69.9 2.75	35.1 1.38	35.1 1.38	25.4 1.00	27.7 1.09	28.2 1.11	
1	149.4 5.88	28.4 1.12	50.8 2.00	52.3 2.06	73.2 2.88	41.1 1.62	41.1 1.62	28.4 1.12	34.5 1.36	35.1 1.38	
1 1/4	158.8 6.25	28.4 1.12	63.5 2.50	63.5 2.50	73.2 2.88	41.1 1.62	41.1 1.62	30.2 1.19	43.2 1.70	43.7 1.72	
1 1/2	177.8 7.00	31.8 1.25	73.2 2.88	73.2 2.75	82.6 3.25	44.5 1.75	44.5 1.75	31.8 1.25	49.5 1.95	50.0 1.97	
2	215.9 8.5	38.1 1.50	91.9 3.62	104.6 4.12	101.6 4.00	57.2 2.25	57.2 2.25	38.1 1.50	62.0 2.44	62.5 2.46	
2 1/2	244.3 9.62	41.1 1.62	104.6 4.12	124.0 4.88	104.6 4.12	63.5 2.50	63.5 2.50	47.8 1.88	74.7 2.94	75.4 2.97	
3	266.7 10.50	47.8 1.88	127.0 5.00	133.4 5.25	117.3 4.62	73.2 2.88	73.2 2.88	50.8 2.00	91.4 3.60	91.4 3.60	
4	311.2 12.25	53.8 2.12	157.2 6.19	162.1 6.38	124.0 4.88	90.4 3.56	90.4 3.56	57.2 2.25	116.8 4.60	116.8 4.60	
5	374.7 14.75	73.2 2.88	185.7 7.31	196.9 7.75	155.4 6.12	104.6 4.12	104.6 4.12	63.5 2.50	144.5 5.69	144.5 5.69	
6	393.7 15.50	82.6 3.25	215.9 8.50	228.6 9.00	171.5 6.75	119.1 4.69	119.1 4.69	69.9 2.75	171.5 6.75	171.5 6.75	
8	482.6 19.00	91.9 3.62	269.7 10.62	292.1 11.50	212.9 8.38	142.7 5.62	142.7 5.62	76.2 3.00	222.3 8.75	222.3 8.75	
10	584.2 23.00	108.0 4.25	323.9 12.75	368.3 14.50	254.0 10.00	158.8 6.25	177.8 7.00	84.1 3.31	277.4 10.92	277.4 10.92	
12	673.1 26.50	124.0 4.88	381.0 15.00	450.9 17.75	282.4 11.12	180.8 7.12	218.9 8.62	91.9 3.62	328.2 12.92	328.2 12.92	
14	749.3 29.50	133.4 5.25	412.8 16.25	495.3 19.50	298.5 11.75		241.3 9.50		360.2 14.18	360.2 14.18	
16	825.5 32.50	146.1 5.75	469.9 18.50	552.5 21.75	311.2 12.25		260.4 10.25		411.2 16.19	411.2 16.19	
18	914.4 36.00	162.1 6.38	533.4 21.00	596.9 23.50	327.2 12.88		276.4 10.88		462.3 18.20	462.3 18.20	
20	984.3 38.75	177.8 7.00	584.2 23.00	641.4 25.50	355.6 14.00		292.1 11.50		514.4 20.25	514.4 20.25	
24	1168.4 46.00	203.2 8.00	692.2 27.25	762.0 30.00	406.4 16.00		330.2 13.00		616.0 24.25	616.0 24.25	

Las medidas en negro están expresadas en milímetros, las de color en pulgadas.

* Los 1.6 mm del Resalto están incluidos en el espesor mínimo, en la altura a través del cuello o cubo y en la longitud roscada mínima. Esta tabla corresponde a bridas de cara con resalto.

Diámetro Nominal del Tubo	Diámetro en el punto de soldadura A	Radio Lj r	Profundidad del Asiento Z	Diámetro del asiento Q	Plantilla de Perforar			Peso Aproximado por Brida				
					Diám.Círculo de Agujeros D	Cantidad	Diám.de Agujeros H	WN	SO	LJ	B	SW
								Kg	Kg	Kg	Kg	Kg
1/2	21.3 0.84	3.0 0.12	9.7 0.38	23.6 0.93	82.6 3.25	4	22.4 0.88	2.3	2.1	2.1	2.1	2.1
3/4	26.7 1.05	3.0 0.12	11.2 0.44	29.0 1.14	88.9 3.50	4	22.4 0.88	3.2	2.8	2.8	2.7	3.2
1	33.5 1.32	3.0 0.12	12.7 0.50	35.8 1.41	101.6 4.00	4	25.4 1.00	4.1	3.9	3.9	4.1	3.6
1 1/4	42.2 1.66	4.8 0.19	14.2 0.56	44.5 1.75	111.3 4.38	4	25.4 1.00	4.5	4.3	4.3	4.5	5.5
1 1/2	48.3 1.90	6.4 0.25	15.7 0.62	50.5 1.99	124.0 4.88	4	28.4 1.12	6.4	6.0	6.0	6.4	7.1
2	60.5 2.38	7.9 0.31	17.5 0.69	63.5 2.50	165.1 6.50	8	25.4 1.00	12.0	10.5	9.5	11.3	9.5
2 1/2	73.2 2.88	7.9 0.31	19.1 0.75	76.2 3.00	190.5 7.50	8	28.4 1.12	16.3	11.3	13.1	15.9	11.7
3	88.9 3.50	9.7 0.38		92.2 3.63	203.2 8.00	8	31.8 1.25	21.8	21	17.2	21.8	
4	114.3 4.50	11.2 0.44		117.6 4.63	241.3 9.50	8	35.1 1.38	34	33	34	33	
5	141.2 5.56	11.2 0.44		144.5 5.69	292.1 11.50	8	41.1 1.62	60	58	63	64	
6	168.4 6.63	12.7 0.50		171.5 6.75	317.5 12.50	12	38.1 1.50	76	72	77	72	
8	219.2 8.63	12.7 0.50		222.3 8.75	393.7 15.50	12	44.5 1.75	124	117	130	137	
10	273.1 10.75	12.7 0.50		276.4 10.88	482.6 19.00	12	50.8 2.00	206	198	220	230	
12	323.9 12.75	12.7 0.50		328.7 12.94	571.5 22.50	16	53.8 2.12	313	303	340	352	
14	355.6 14.00	12.7 0.50		360.4 14.19	635.0 25.00	16	60.5 2.38					
16	406.4 16.00	12.7 0.50		411.2 16.19	704.9 27.75	16	66.5 2.62					
18	457.2 18.00	12.7 0.50		462.0 18.19	774.7 30.50	16	73.2 2.88					
20	508.0 20.00	12.7 0.50		512.8 20.19	831.9 32.75	16	79.2 3.12					
24	609.6 24.00	12.7 0.50		614.4 24.19	990.6 39.00	16	91.9 3.62					

Las medidas en negro están expresadas en milímetros, las de color en pulgadas.



BRIDAS EMI GROUP S.A.

info@bridasemi.com.ar

www.bridasemi.com.ar

Rondeau 1560 Wilde, Buenos Aires. Argentina

Tel: 4220 -4414 4414 /4289 4572 - 4289 2030 / 4137 7325